

## Angle Base Cabinets

AVAILABLE OPTIONS ARE SHADED

AF	BBD	BO	CFG	FAS	FC	FE	FF	FTK	IT	MD/MD9	MI	NODR	NTK	PFC	PLYB	PLYE	RTB	SCD	SCH	SLB	TOT	XS	XX
----	-----	----	-----	-----	----	----	----	-----	----	--------	----	------	-----	-----	------	------	-----	-----	-----	-----	-----	----	----

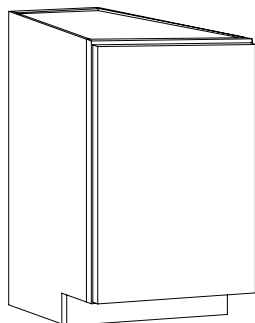

ABC12L  
ABC12R

### NOTES:

- Cabinet sides are 12" D to 24" D
- Door is always hinged on the 12" side
- 12" side has 45° corner
- 24" side has 135° corner
- Maximum reduction is 18. This makes the 12" ABC side 6" deep when reduced to 18"
- Left shown
- Top view and dimensions in Introduction sections

## Angle Base End Cabinet

AVAILABLE OPTIONS ARE SHADED

AF	BBD	BO	CFG	FAS	FC	FE	FF	FTK	IT	MD/MD9	MI	NODR	NTK	PFC	PLYB	PLYE	RTB	SCD	SCH	SLB	TOT	XS	XX
----	-----	----	-----	-----	----	----	----	-----	----	--------	----	------	-----	-----	------	------	-----	-----	-----	-----	-----	----	----

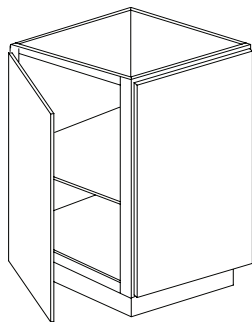

ABE24

### NOTES:

- Comes with 1 shelf
- 22 1/2° front corner
- Top view and dimensions in Introduction sections